

# MATERIAL FLOW AND FACTORY EQUIPMENT SUPERMARKET



DEMAND-ORIENTED SUPPLY FOR A  
FLOWING PRODUCTION.

# BLOKSMA

## FLOWING PROCESSES FOR MORE THAN 95 YEARS

BLOKSMA-Engineering – a name that has become synonym for professional material flow and technically mature workpiece carriers.

Starting in 1920 with a mechanical production, BLOKSMA has turned into the absolute specialist for efficient production logistics.

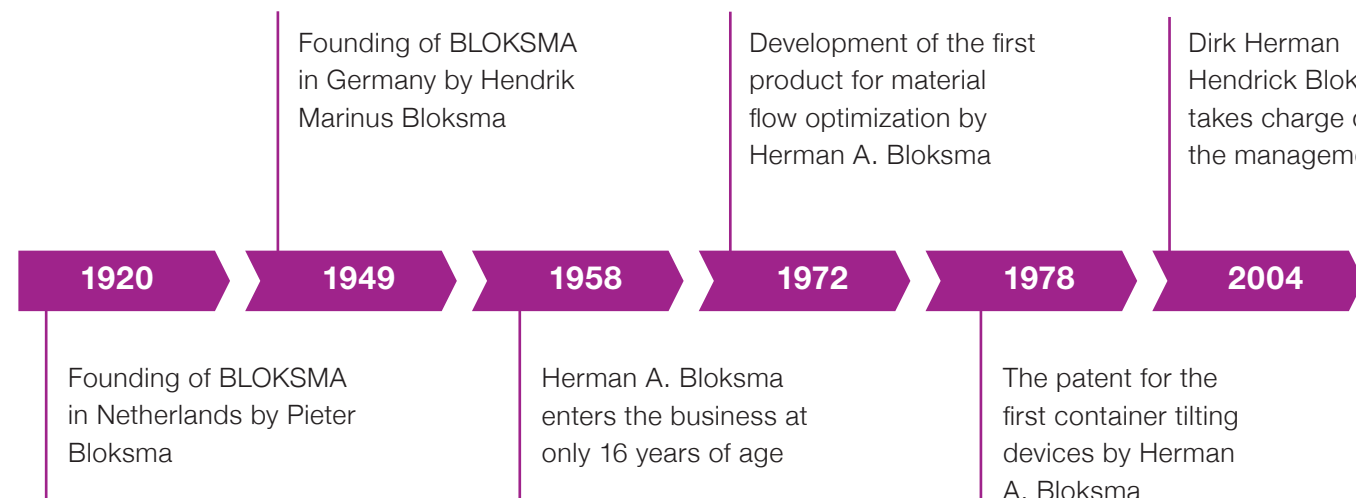



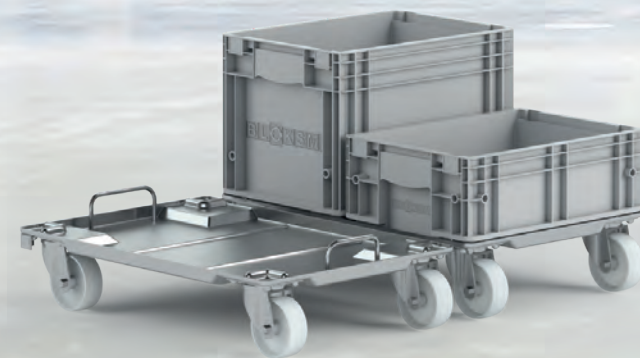

### Well known companies trust in BLOKSMA solutions:

AEG · Allweiler · AMG · Arburg · Atlas Copco · Audi · Behr · Benzinger · Beru · Bitzer · BMW  
Danfoss · Eaton · Eberspächer · ebmpapst · EMAG · FAG · Faurecia · Federal Mogul · Fein  
Hansgrohe · Hatz · Heidelberg · Hella · Husky · IFA · INA · John Deere · Knipex  
Mercedes Benz · Metabo · Miele · Nidec · Opel · Parker · Pierburg · Porsche · Promat  
Wabco · Wago · ZF

Boge · Borg Warner · Bosch · Brose · BRP-Rotax · BSH · Caterpillar · Continental · Daimler  
Felsomat · Festo · Ford · Gardena · Gemü · Georg Fischer · Getrag · GKN · Grob · Güdel  
Kodak · KUKA · Liebherr · LUK · Lütze · Magna · Magna Steyr · Mahle · MAN · Mannesmann  
Schaeffler · SEW · Stihl · thyssenkrupp · Traub · Valeo · Vibracoustic · Volkswagen · Vorwerk



# OPTIMIZE YOUR “PRODUCTIVITY FACTOR” PFA

## What is the PFA?

The Productivity Factor establishes the relationship between the total duration of the product cycle and the duration of the actual value creation process. The factor can be optimised by reducing the activities which do not generate added value such as the material transport from one processing station to the next.

PFA =

Time overall

Time value-creation

**Time overall**  
delivery, production time, internal transport, waiting/storage time, delivery

**Time value-creation**  
processing, assembly, machine operating times



## LET’S USE THE CONCRETE EXAMPLE OF A MANUFACTURER FOR PROFESSIONAL POWER TOOLS

BEFORE	AFTER
Lead time / working day 1587 min Value cration <small>estimated</small> 200 min	Lead time / working day 595 min Value creation <small>estimated</small> 200 min
<b>PFA = <math>\frac{1587 \text{ min}}{200 \text{ min}} = 7.94</math></b>	<b>PFA = <math>\frac{595 \text{ min}}{200 \text{ min}} = 2.98</math></b>
Stock 4,950,000 €	Stock 1,600,000 €

<b>SAVINGS</b>	
Time savings through trolley usage	per working day <b>992 min</b>
Interest gained through lead time reduction from 8 to 3 working days	per working day <b>1,315 €</b>
Stock reduction	per year <b>3,170,000 €</b>
Total investment	about <b>90,000 €</b>

## Objectives

- increased efficiency
- ground-level storage without shelves and forklifts
- reduction of transit stocks by 2/3
- halving the lead times
- higher productivity per unit area
- improved ergonomics

## Solution approach: Getting “the production moving”

- modern lay-out with just-in-time principle as flow production
- removal of high shelves with a roller conveyor
- forklift- free zones
- reduction of walk and search paths as well as manual repacking and restacking
- uniform SLC containers from the supplier to the customer



SUPERMARKETS

Demand-oriented supply for a flowing production.

BLOKSMA supermarkets are designed for the need-oriented provision of goods – clearly arranged and in the right quantity. What are you looking for?

You can purchase your daily needs at the supermarket, right? Although in modern companies this term is used to describe areas in which all required material for production is provided and supplied. On the basis of the First-in-First-out-principle and Kanban-planning the supermarkets by BLOKSMA fulfill a multitude of the most diverse requirements. Primarily, they ensure

in the smallest of spaces quick access to goods which are stored on trolleys and intended for immediate consumption. Here again we are your partner for everyday as well as special solutions. All our supermarket components have a modular structure and are tailor-made exactly to your requirements – with helpful additional elements and comfortable details.



OVERVIEW

PRODUCT INFORMATION	Pages 140-143
SUPERMARKET STRUCTURE ALUMINIUM SW 41mm	Pages 144-145
SINGLE COMPONENTS ALUMINIUM G3 SW 41mm	Pages 146-149
SUPERMARKET STRUCTURE G3 SW 52mm	Pages 150-151
SINGLE COMPONENTS ALUMINIUM G3 SW 52mm	Pages 152-155
FURTHER VARIATIONS	Pages 156-157
SIGNAGE FOR SUPERMARKETS	Pages 158-165
ACCESSORIES	Pages 166-169

SUPERMARKET  
CHECKLIST

generation	G3 (aluminium)	<input type="checkbox"/>	G2 (steel)	<input type="checkbox"/>
track width	41 mm (G3 aluminium)	<input type="checkbox"/>	42 mm (G2 steel)	<input type="checkbox"/>
	52 mm (G3 aluminium)	<input type="checkbox"/>	95 mm (G2 steel)	<input type="checkbox"/>
	special measurement (please fill in)	<input type="text" value="mm"/>	special measurement (please fill in)	<input type="text" value="mm"/>
number of trolleys next to each other	<input type="text"/>			
number of trolleys one after another	<input type="text"/>			
trolley attributes	manufacturer	<input type="text"/>	item number/ type description	<input type="text"/>
	length	<input type="text" value="mm"/>	width	<input type="text" value="mm"/>
	track width	<input type="text" value="mm"/>		
	wheel diameter	<input type="text" value="mm"/>	wheel width	<input type="text" value="mm"/>
			protrusion (ÜS)	<input type="text" value="mm"/>
	wheel combination		2 swivel & 2 fixed wheels	<input type="checkbox"/>
			4 swivel wheels	<input type="checkbox"/>
			4 swivel & 2 fixed wheels	<input type="checkbox"/>
	brake	no <input type="checkbox"/>	yes <input type="checkbox"/>	
			how many?	<input type="text"/>
		position?	<input type="text"/>	
directional lock	no <input type="checkbox"/>	yes <input type="checkbox"/>		
		how many?	<input type="text"/>	
		position?	<input type="text"/>	
Should your trolley have any other specifications such as a top tray, please send us a technical drawing and photo.				
entry direction	lengthwise	<input type="checkbox"/>	crosswise	<input type="checkbox"/>
	supermarket function	go through <input type="checkbox"/>	one sided in & out	<input type="checkbox"/>
infeed elements entry	plastic black	<input type="checkbox"/>	plastic yellow	<input type="checkbox"/>
	plastic red	<input type="checkbox"/>	plastic other colour	<input type="checkbox"/>
	steel-galvanized	<input type="checkbox"/>	others	<input type="text"/>
infeed elements exit	plastic black	<input type="checkbox"/>	plastic yellow	<input type="checkbox"/>
	plastic red	<input type="checkbox"/>	plastic other colour	<input type="checkbox"/>
	steel-galvanized	<input type="checkbox"/>	others	<input type="text"/>

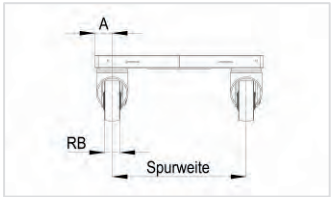
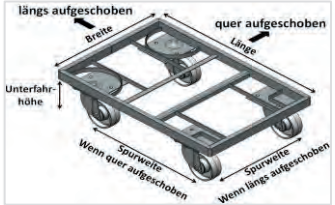

stopping function – brake	none	<input type="checkbox"/>	entry side (front)		exit side (back)	
	brush brake	<input type="checkbox"/>	<input type="checkbox"/>		<input type="checkbox"/>	
	mechanic stopper foot switch	<input type="checkbox"/>	<input type="checkbox"/>		<input type="checkbox"/>	
	electric stopper push button €€€	<input type="checkbox"/>	<input type="checkbox"/>		<input type="checkbox"/>	
	return stop	<input type="checkbox"/>	<input type="checkbox"/>		<input type="checkbox"/>	
	"extra strong" return stop	<input type="checkbox"/>	<input type="checkbox"/>			
labeling	none	<input type="checkbox"/>			<input type="checkbox"/>	
	bothsided	<input type="checkbox"/>	in the middle		<input type="checkbox"/>	
sort of labeling	H = hanging	<input type="checkbox"/>	B = standing		<input type="checkbox"/>	
	K = by a chain	<input type="checkbox"/>	P = standing on		<input type="checkbox"/>	
	rotatable	<input type="checkbox"/>	aluminium profile			
labeling size	A5 <input type="checkbox"/>	A4 <input type="checkbox"/>	A3 <input type="checkbox"/>			
labeling - colour placard frame	blue	<input type="checkbox"/>	yellow		<input type="checkbox"/>	
	green	<input type="checkbox"/>	red		<input type="checkbox"/>	
	black	<input type="checkbox"/>	white		<input type="checkbox"/>	
	other colours	<input type="text"/>				
labeling - height	1,500 mm	<input type="checkbox"/>	2,100 mm		<input type="checkbox"/>	
vertical module	2,400 mm	<input type="checkbox"/>	other height		<input type="text" value="mm"/>	
	<div><div>measurement A (distance from wheel to vertical module)</div><input type="text" value="mm"/></div>					
options	dowelling to the floor	<input type="checkbox"/>	mounting by BLOKSMA		<input type="checkbox"/>	



# SUPERMARKT DIVERSE BRAKING SYSTEMS

## A – RETURN STOP

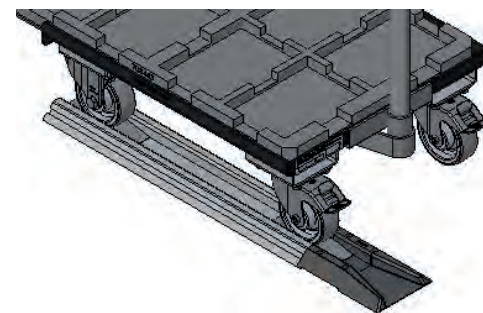
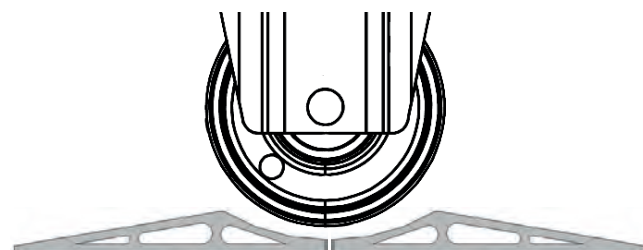

## B – BRUSH BRAKE



Big gap – minor brake effect

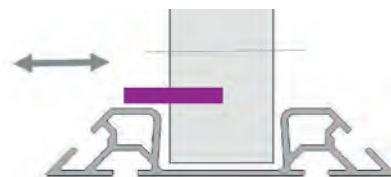

Small gap – major brake effect

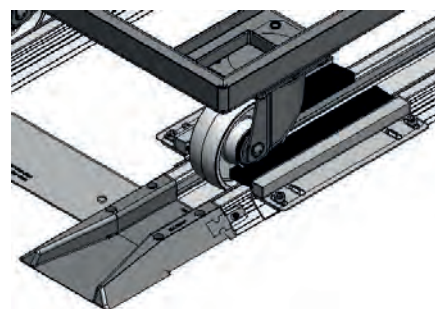

## C – MECHANICAL OR ELECTRICAL LOCKED STOPPER

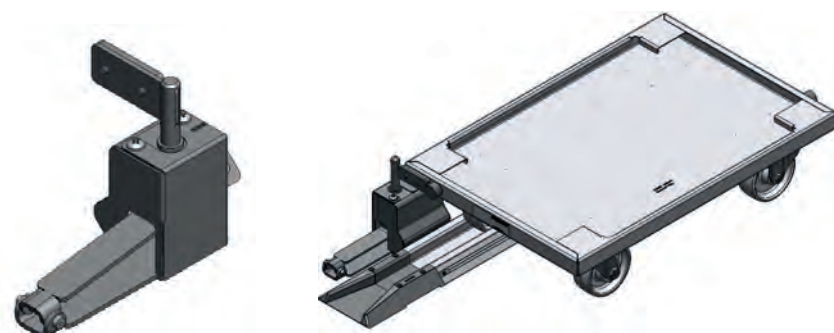

## D – BACK STOP

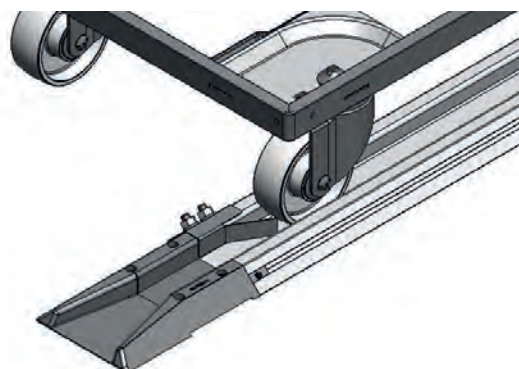

Due to the back stop the supermarket is only accessible in one direction.

# SUPERMARKET ASSEMBLY INSTRUCTION

FIND THE CORRECT DIMENSIONS OF THE REQUIRED SURFACE

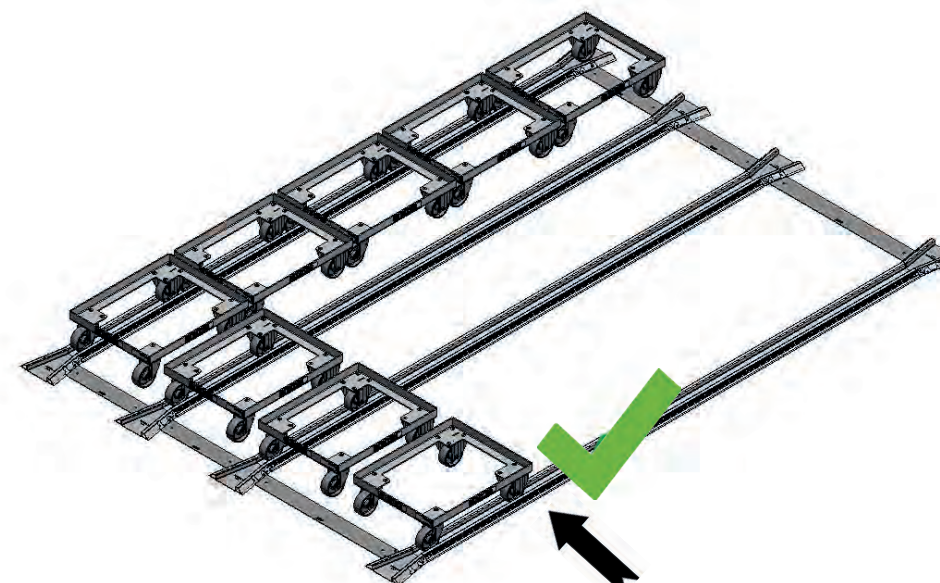

The end closure section serves as a lateral limitation of the supermarket.

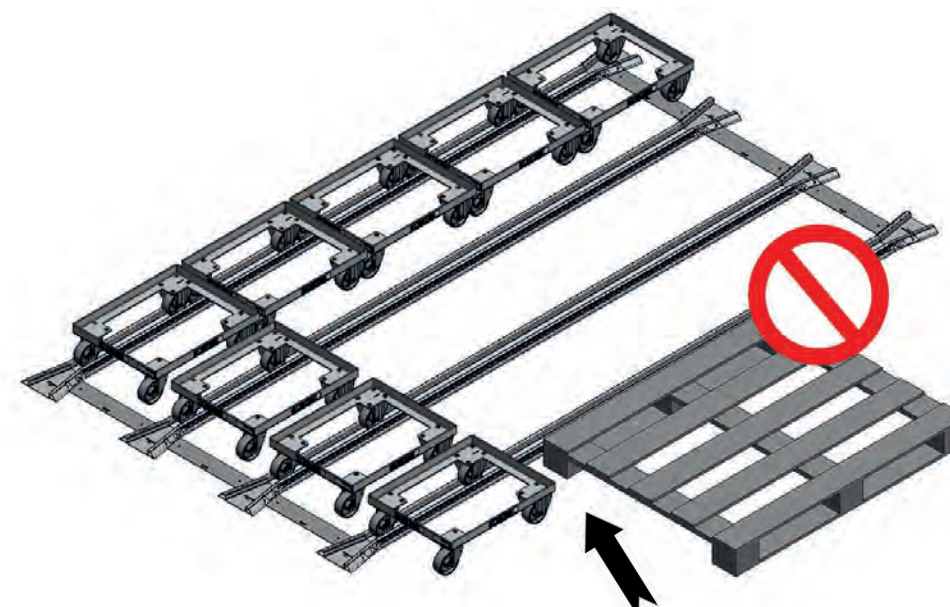

The end closure section is missing. So there is a risk that „obstacles“ are placed inside the supermarkets' space.



SUPERMARKET G3 ALUMINIUM  
SINGLE COMPONENTS SW 41



One-sided wheel guidance – single line system

The rail width (SW) 41mm is suitable for trolleys with a maximum wheel width of 40mm.

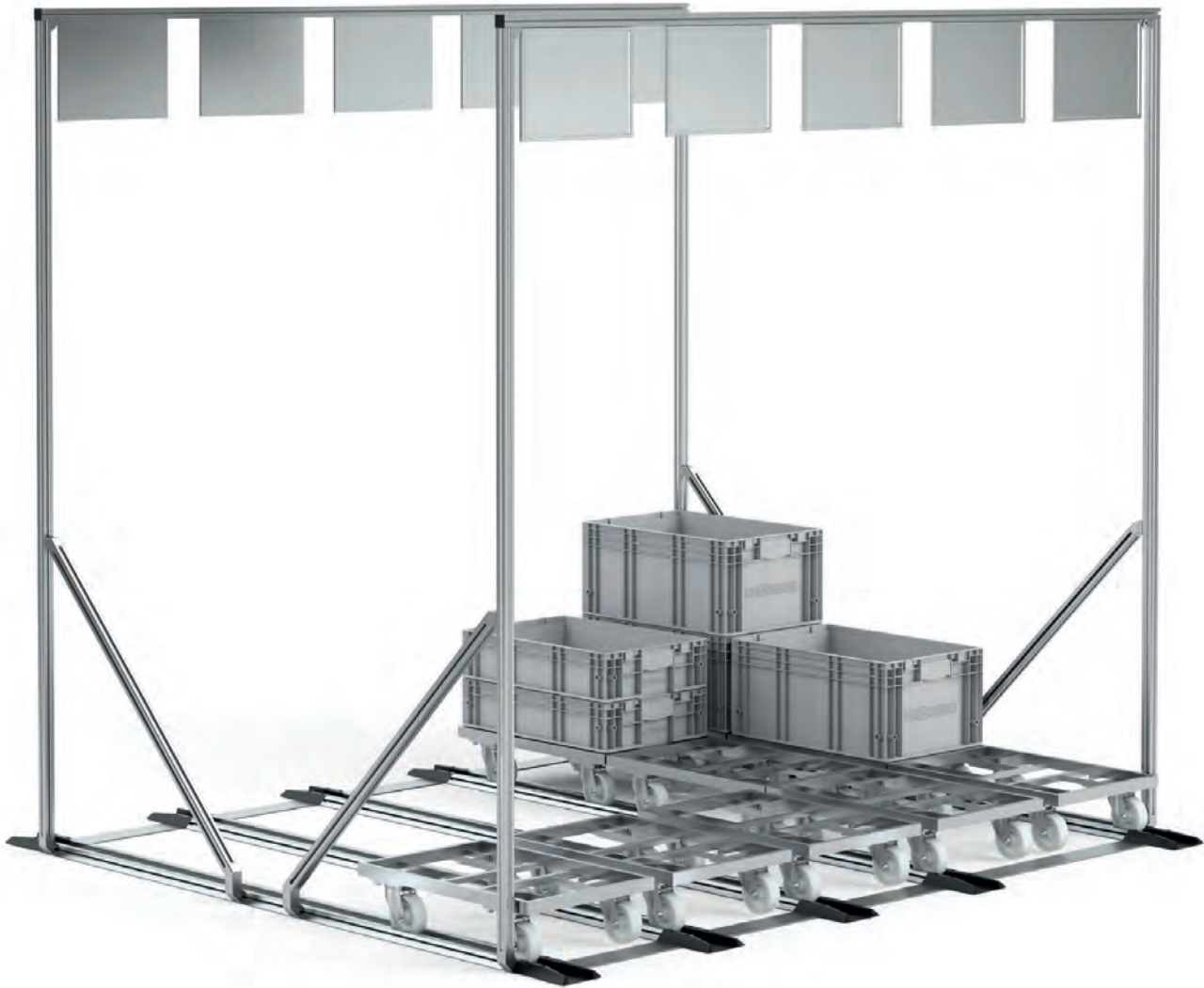

SUPERMARKET G3 ALUMINIUM  
SINGLE COMPONENTS SW 41

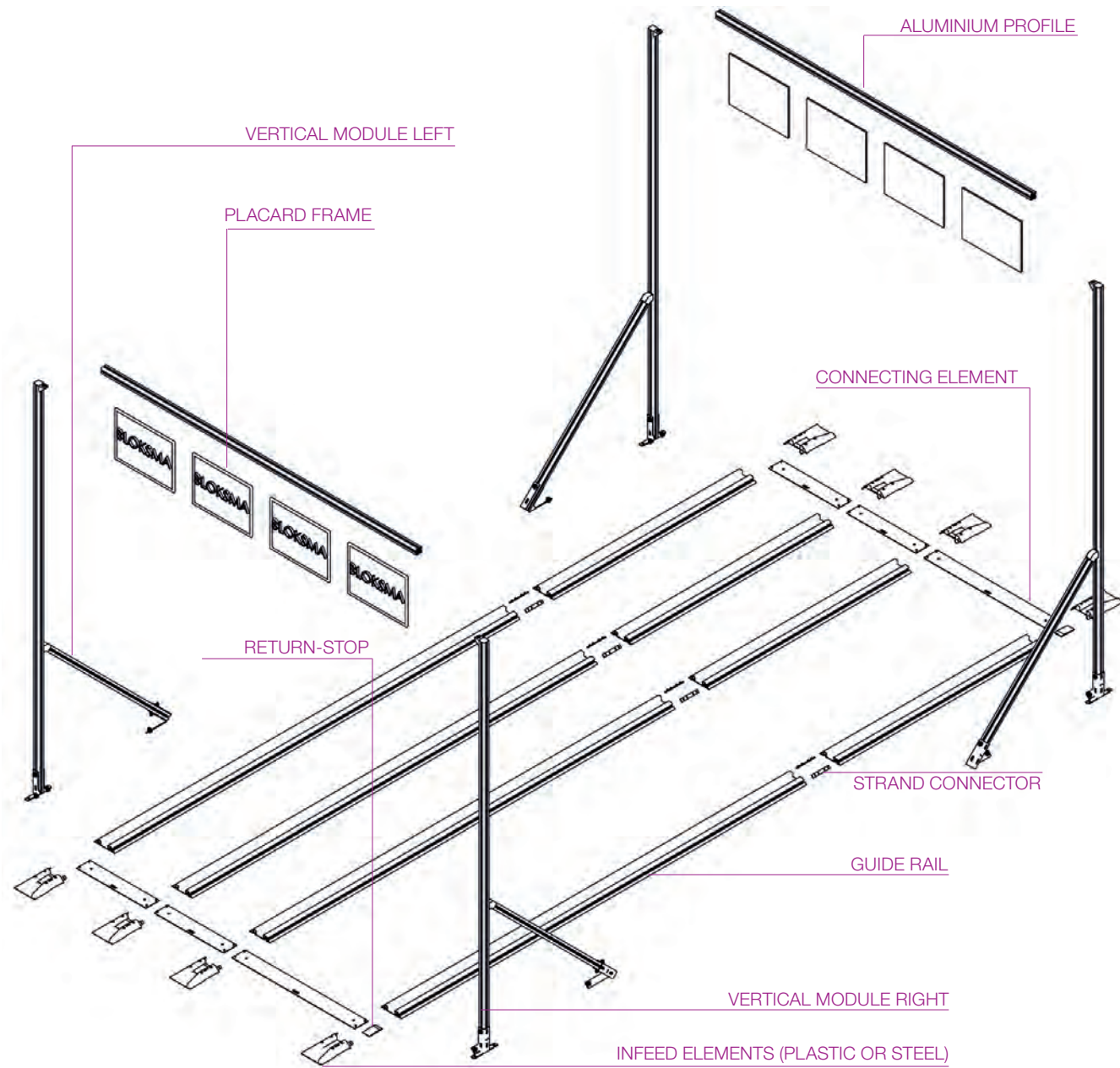

LABELING POSSIBILITIES

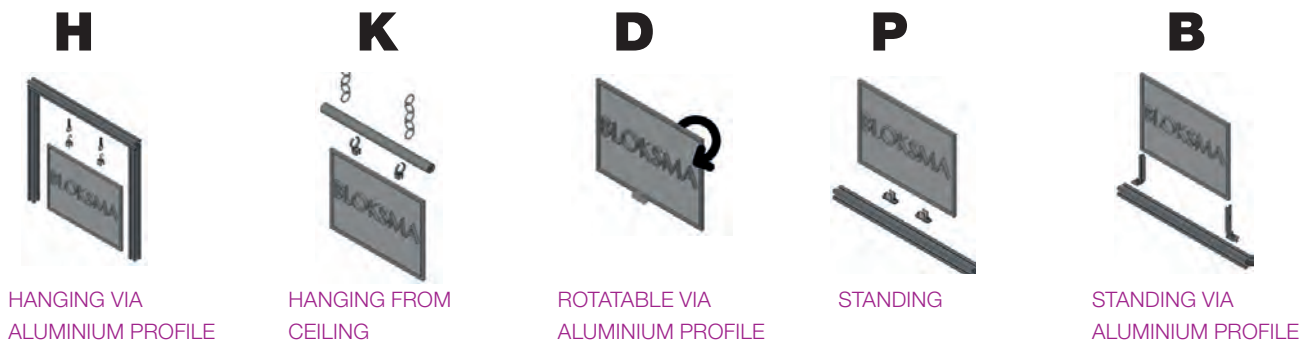



SUPERMARKET G3 ALUMINIUM  
SINGLE COMPONENTS SW 41

Infeed elements and guidance rails

The supermarket organises the material provision according to the FIFO principle. Due to the modular structure each supermarket is adjusted to your individual requirements resp. spatial conditions. The track width /SW) 41 mm is suitable for trolleys with a **maximum wheel width of 40 mm**.

Construct your own supermarket with our single components or use the checklist in the catalogue for guidance. You can also use our online inquiry form or contact us directly with questions or concerns. We are happy to help you with the design.

INFEED ELEMENTS SW 41mm

Item no.	description	paint
138124-9005	Infeed element (plastic)	black RAL 9005
138124-1021	Infeed element (plastic)	yellow RAL 1021
138124-2009	Infeed element (plastic)	orange RAL 2009
138124-5002	Infeed element (plastic)	ultramarine RAL 5002
138124-6016	Infeed element (plastic)	turquoise green RAL 6016
138124-3001	Infeed element (plastic)	red RAL 3001
further colors on request		
210667	Infeed element (steel)	electrogalvanized (very robust)

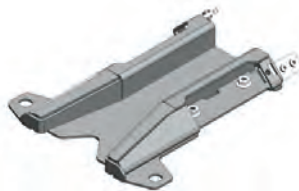
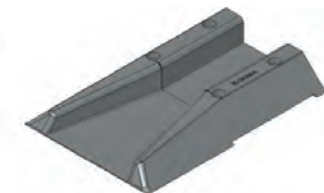

GUIDANCE RAILS SW 41mm

Example: **138318-0800A** anodised aluminium rail with a length of 800mm

Item no.	length	processing
138318-xxxxx	_____	_____
Please enter the desired length of the profile here A = galvanized E = yellow (alike RAL 1021)		
132917-xxxx	cover profile for guidance rails 8er groove (max. 2,000mm)	Plastic

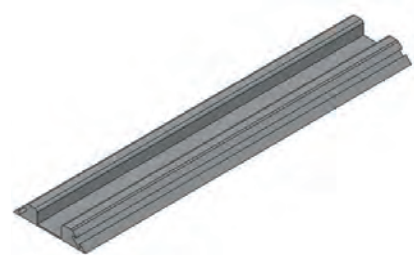
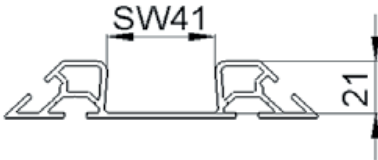

Other models / dimensions on request  
Subject to technical changes

SUPERMARKET G3 ALUMINIUM  
SINGLE COMPONENTS SW 41

Connection elements and stoppers

The rail width (SW) 41mm is suitable for trolleys with a **maximum wheel width of 40 mm**.

CONNECTING ELEMENT

Item no.	description	designed to	model
211451-xxxx	BG-connector with variable rail lenght		
201500-0396	BG-connector lengthwise interposed	trolley 600x400mm model BOF	
201500-0714	BG-connector lengthwise interposed	trolley 600x400mm model BOF	
201500-0596	BG-connector crosswise interposed	trolley 600x400mm model BOF	
201500-0996	BG-connector crosswise interposed	trolley 600x400mm model BOF	
201500-0796	BG-connector crosswise interposed	trolley 800x600mm model BOF	
201500-1514	BG-connector crosswise interposed	trolley 800x600mm model BOF	
201500-0460	BG-connector lengthwise interposed	trolley 630x430mm model BOZ	
201500-0785	BG-connector lengthwise interposed	trolley 630x430mm model BOZ	
142327	BG-shackles		
138759	connecting element check rail		

lengthwise

crosswise

fowel flap

connecting element for  
guide rail

STOPPER

Item no.	description	designed to	model
141427-0040A	non-return device 10mm	check rail SW 41	
144417-0040A	non-return device 6mm	check rail SW 41	
142073	end stop - rail	check rail SW 41	
139621	brush brake - retrofit	aluminium check rail	
202219-LI	ZB-stopper left	aluminium check rail	
202219-RE	ZB-stopper right	aluminium check rail	

non return device

end stop

brush brake

Stopper

Other models / dimensions on request  
Subject to technical changes



SUPERMARKET G3 ALUMINIUM  
SINGLE COMPONENTS SW 41

Labeling and vertical modules

The rail width (SW) 41mm is suitable for trolleys with a maximum wheel width of 40mm.

VERTICAL MODULE

Example: 202216-L2100 BG-vertical module left, height 2,100mm

Item no.	lenght/height	description	dimensi-on A	model
202216-L_ _ _ _	_ _ _ _ _	BG vertical module left for trolley 600x400 mm model BOF	measure A 41mm	
202216-R_ _ _ _	_ _ _ _ _	BG vertical module right for trolley 600x400 mm model BOF	measure A 41mm	
202247-L_ _ _ _	_ _ _ _ _	BG vertical module left for trolley 630x430 mm model BOZ	measure A 52,5mm	
202247-R_ _ _ _	_ _ _ _ _	BG vertical module right for trolley 630x430 mm model BOZ	measure A 52,5mm	

Please enter the desired height of the aluminium profile here.

Please contact us if the mesurement A of your trolley is not listed, so that we can design and calculate the accurate verticle module for your supermarket.

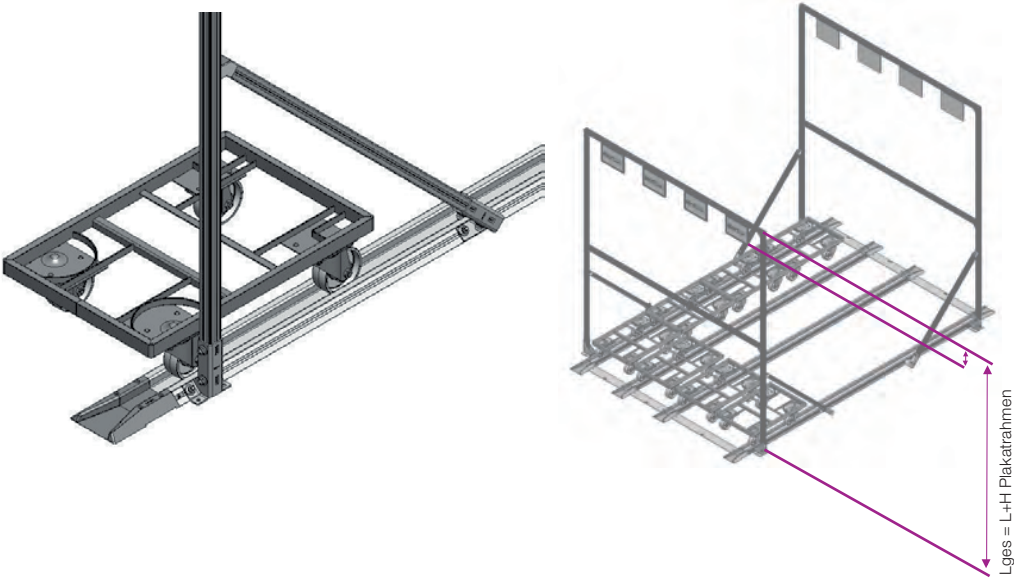



Please take into account the height of the placard frame when calculating the option ‚hanging connection‘. The total height. **Lges** = desired passage height + height of the placard frame

SUPERMARKET G3 ALUMINIUM  
SINGLE COMPONENTS SW 41





Connection elements and stoppers

The rail width (SW) 41mm is suitable for trolleys with a maximum wheel width of 40mm.

PROFILE HOLDER

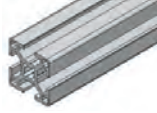
Item no.	description	designed to	model
202237-V	BG-profile holder in front	trolley BOF 600x400mm	
202237-L	BG-profile holder left	trolley BOF 600x400mm	
202237-R	BG-profile holder right	trolley BOF 600x400mm	
202236-V	BG-profile holder in front	trolley BOZ 630x430mm	
202236-L	BG-profile holder left	trolley BOZ 630x430mm	
202236-R	BG-profile holder right	trolley BOZ 630x430mm	
209702-V	BG-profile holder movable	diverse trolleys	
202217	BG-profile holder round pipe	trolley BOF 600x400mm	
202979-L	stabiliser left	trolley BOF 600x400mm	
202979-R	stabiliser right	trolley BOF 600x400mm	

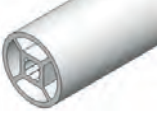
ALUMINIUM PROFILE

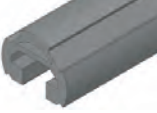
Item no.	lenght	processing	description	model
132401	_ _ _ _ _	A	aluminium profile 30x30mm labeling from ceiling or with vertical modules possible	 
132404	_ _ _ _ _	A	aluminium profile Ø 28mm labeling from ceiling	 
142419	_ _ _ _ _	A	aluminium profile round Ecoshape labeling from ceiling ith vertical modules possible	 

please insert preferred rail height A = anodized



SUPERMARKT G3 ALUMINIUM  
SINGLE COMPONENTS SW 52

Connection elements and stoppers

The rail width (SW) is suitable for trolleys with a  
maximum wheel width of 50mm.



SUPERMARKT G3 ALUMINIUM  
SINGLE COMPONENTS SW 52

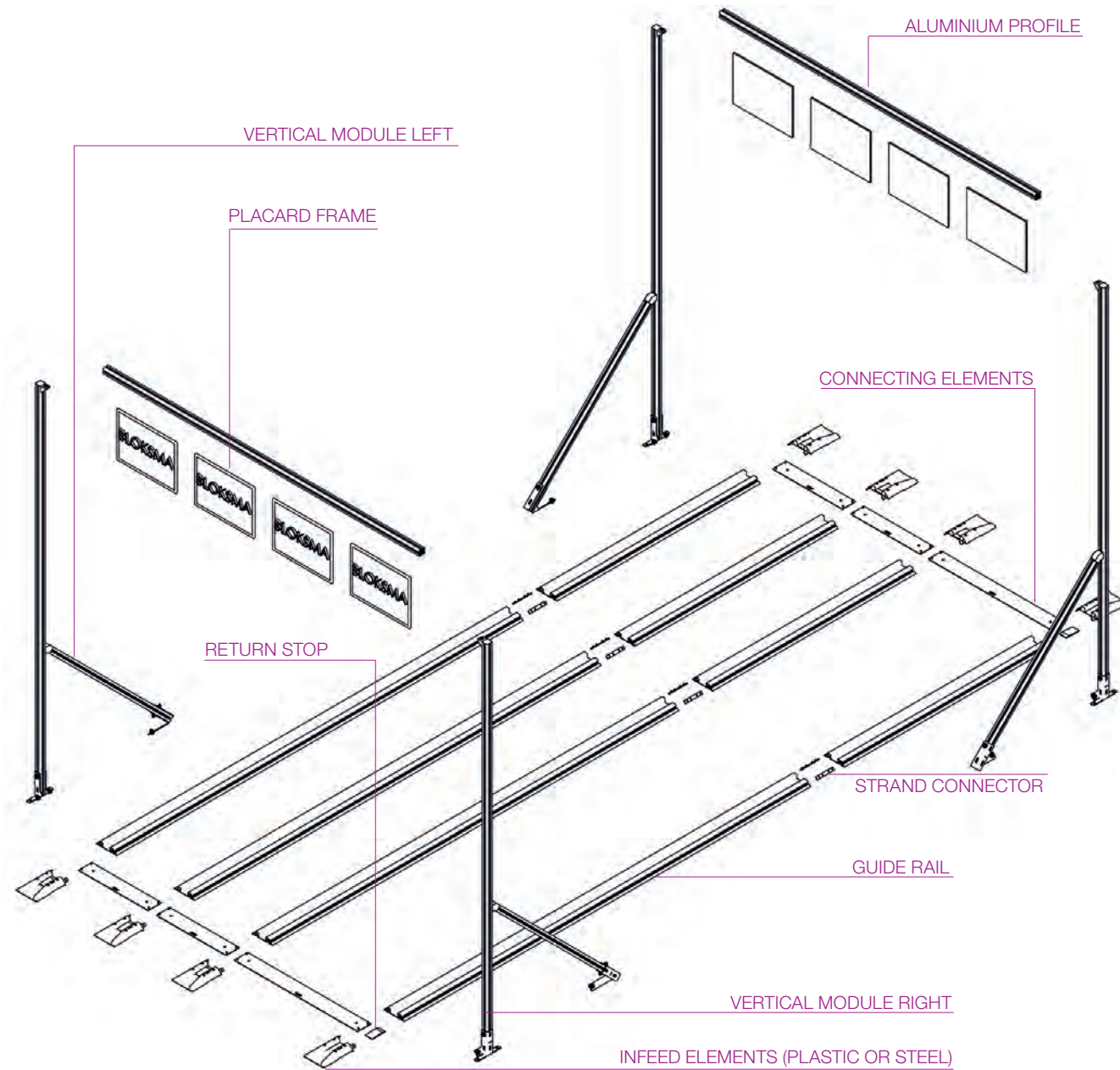

LABELING POSSIBILITIES

**H**



HANGING VIA  
ALUMINIUM PROFILE

**K**

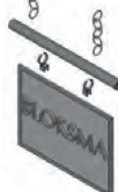

HANGING FROM  
CEILING

**D**



ROTATABLE VIA  
ALUMINIUM PROFILE

**P**



STANDING

**B**



STANDING VIA  
ALUMINIUM PROFILE



SUPERMARKET G3 ALUMINIUM  
SINGLE COMPONENTS SW 52



Infeed elements and guide rails

The supermarket organises the material provision according to the FIFO principle. Due to the modular structure each supermarket is adjusted to your individual requirements resp. spatial conditions. The track width /SW) 52 mm is suitable for trolleys with a **maximum wheel width of 50 mm**.

Construct your own supermarket with our single components or use our checklist in the catalogue. You can also use our online inquiry form or contact us directly with questions or concerns. We are happy to take over the design for you.

INFEED ELEMENTS SW 52mm

Item no.	desription	paint
148618-9005	infeed element plastic	black RAL 9005
148618-1021	infeed element plastic	yellow RAL 1021
148618-2009	infeed element plastic	orange RAL 2009
148618-5002	infeed element plastic	ultramarine RAL 5002
148618-6016	infeed element plastic	turquoise green RAL 6016
148618-3001	infeed element plastic	red RAL 3001
weitere Farben auf Anfrage möglich		
211365	infeed element steel	galv. verzinkt (sehr robust)

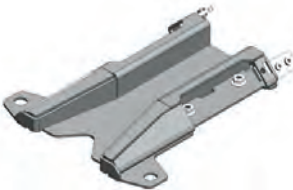
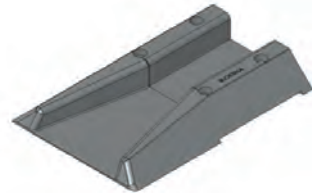

GUIDE RAILS SW 52mm

Example: **148448-0800A** anodised Aluminium rail with a length of 800 mm

Item no.	length	processing
148448-xxxxx	_____	_____
please insert preferred rail length.		A = anodized E = yellow (similarly RAL 1021)
132917-xxxx	cover profile for check rail 8er Nut (max. 2000mm)	plastic

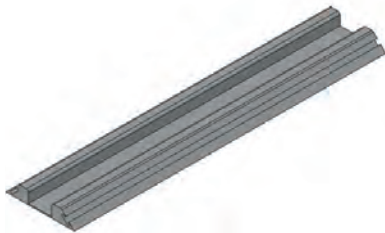
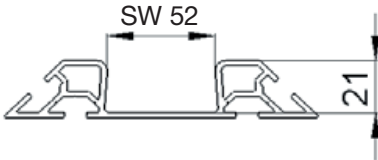

Other models / dimensions on request  
Subject to technical changes

SUPERMARKET G3 ALUMINIUM  
SINGLE COMPONENTS SW 52



Connecting elements and stoppers

The rail width (SW) 52mm is suitable for trolleys with a **maximal wheel width of 50mm**.

CONNECTING ELEMENT

Item no.	description	designed to	model
201500-xxxxx	BG-connector lengthwise interposed	depending on the track spacing to the outer edge of the trolley	
201500-xxxxx	BG-connector crosswise interposed	depending on the track spacing to the outer edge of the trolley	
211451-xxxxx	BG-connector with variable rail length		
		inserted lengthwisei	inserted crosswise
142327	BG-Dübellasche		
138759	connecting element check rail		
			dowel flap
			connecting element for guide rail

STOPPER

Item no.	description	designed to	model
141427-0050A	non-return 10mm	check rail SW 52	
144417-0050A	non-return 6mm	check rail SW 52	
200400	end stop - rail	check rail SW 52	
139621	brush brake - retrofit	aluminium check rail	
202219-LI	ZB-stopper left	aluminium check rail	
202219-RE	ZB-stopper right	aluminium check rail	
			brush brake
			endstop
			Stopper

Other models / dimensions on request  
Subject to technical changes



SUPERMARKET G3 ALUMINIUM  
SINGLE COMPONENTS SW 52

Labeling and vertical modules

The rail width (SW) 52mm is suitable for trolleys with a  
**maximal wheel width up to 50mm.**

VERTICAL MODULE

Example: **202255-L2100** BG-verticle module left with a height of 2.100mm

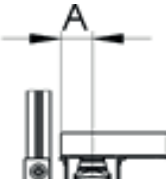
Item no.	length	desription	dimensi-on A	model
202255-L	_____	BG-vertical module left	dimension A 60mm	
202255-R	_____	BG-vertical module	dimension A 60mm	

Please enter the desired  
height of the alu-profile  
here.

Please contact us if the mesurement A  
of your trolley is not listed, so that we  
can design and calculate the accurate  
verticle module for your supermarket.

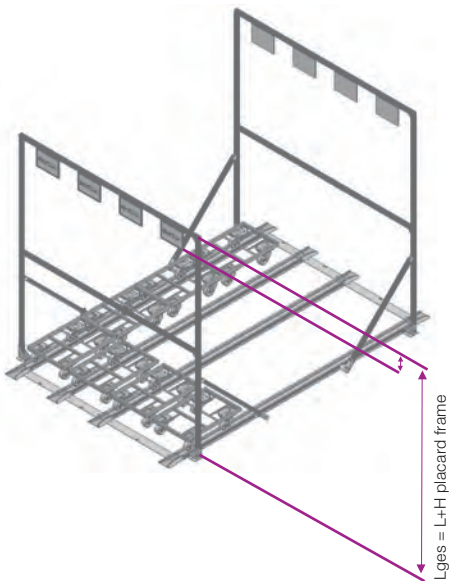
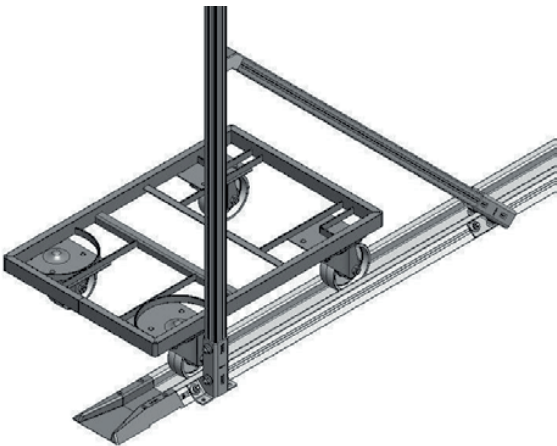

Please take into account the height of the placard frame when  
calculating the option ‚hanging connection‘. The total height  
Lges = desired passage height + height of the placard frame

Other models / dimensions on request  
Subject to technical changes

SUPERMARKET G3 ALUMINIUM  
SINGLE COMPONENTS SW 52

Profile holders and aluminium profiles

The rail width (SW) 52mm is suitable for trolleys with a  
**maximal wheel width of 50mm.**

PROFILE HOLDER

Item no.	description	designed to	model
202256-V	BG-profile holder in front	designed for trolley swith a maximum wheel width up to 50mm	
202256-L	BG-profile holder left	designed for trolley swith a maximum wheel width up to 50mm	
202256-R	BG-profile holder right	designed for trolley swith a maximum wheel width up to 50mm	
209702-V	BG-profile holder movable	diverse trolley	
202217	BG-profile holder round pipe	designed for trolley swith a maximum wheel width up to 50mm	
202979-L	stabiliser left	designed for trolley swith a maximum wheel width up to 50mm	
202979-R	stabiliser right	designed for trolley swith a maximum wheel width up to 50mm	

ALUMINIUM PROFILE

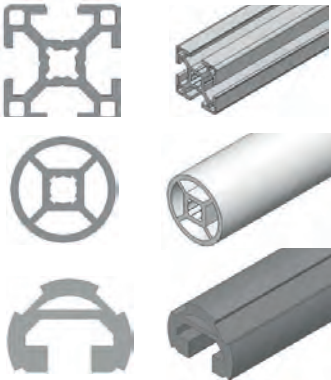
Item no.	length	processing	description	model
132401	_____	A	aluminium profile 30x30 mm labeling from ceiling or with verti- cal modules possible	
132404	_____	A	aluminium profile Ø 28mm labeling from ceiling	
142419	_____	A	aluminium profile round Ecos- hape labeling from ceiling with vertical modules possible	

Please fill in the reques-  
ted length of the rail. A = anodized

Other models / dimensions on request  
Subject to technical changes



SUPERMARKET G2/G6 STEEL/  
STAINLESS STEEL  
AVAILABLE IN SW 42 / SW 52

OUR BLOKSMA SUPERMARKET IS ALSO AVAILABLE IN STEEL

You can either send in your enquiry with the checklist in the catalogue, use the online-request-form or contact us directly. We are happy to do the design for you.

- 3

42

The rail width (SW) 42mm is suitable for trolleys with a maximal wheel width of 40mm.
- 52

The rail width (SW) 52mm is suitable for trolleys with a maximal wheel width of 50mm.

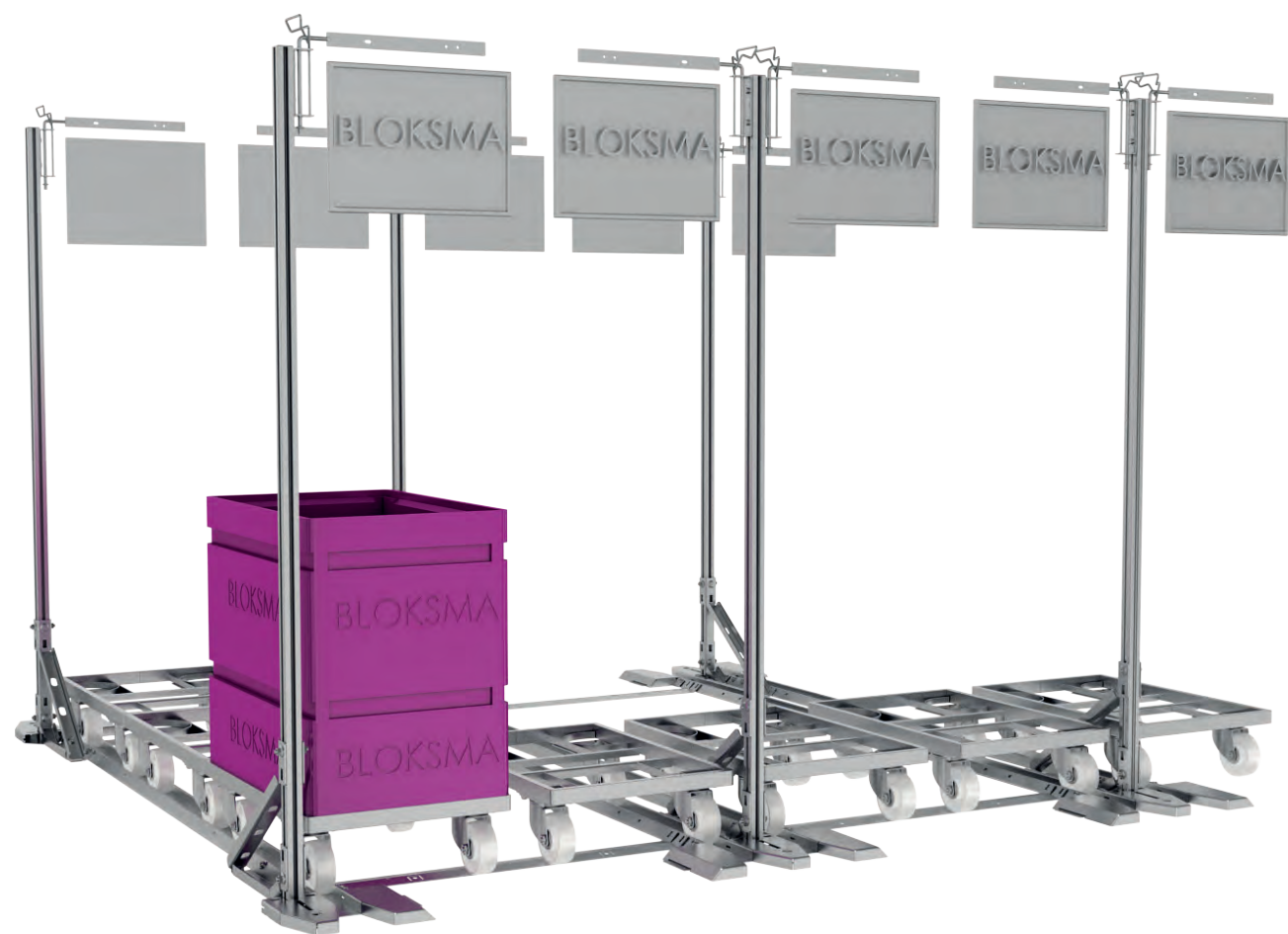

SUPERMARKET G2/G6 STEEL  
SINGLE COMPONENTS SW 42 / SW 52

Steel or stainless steel  
(eg. for medical engineering)

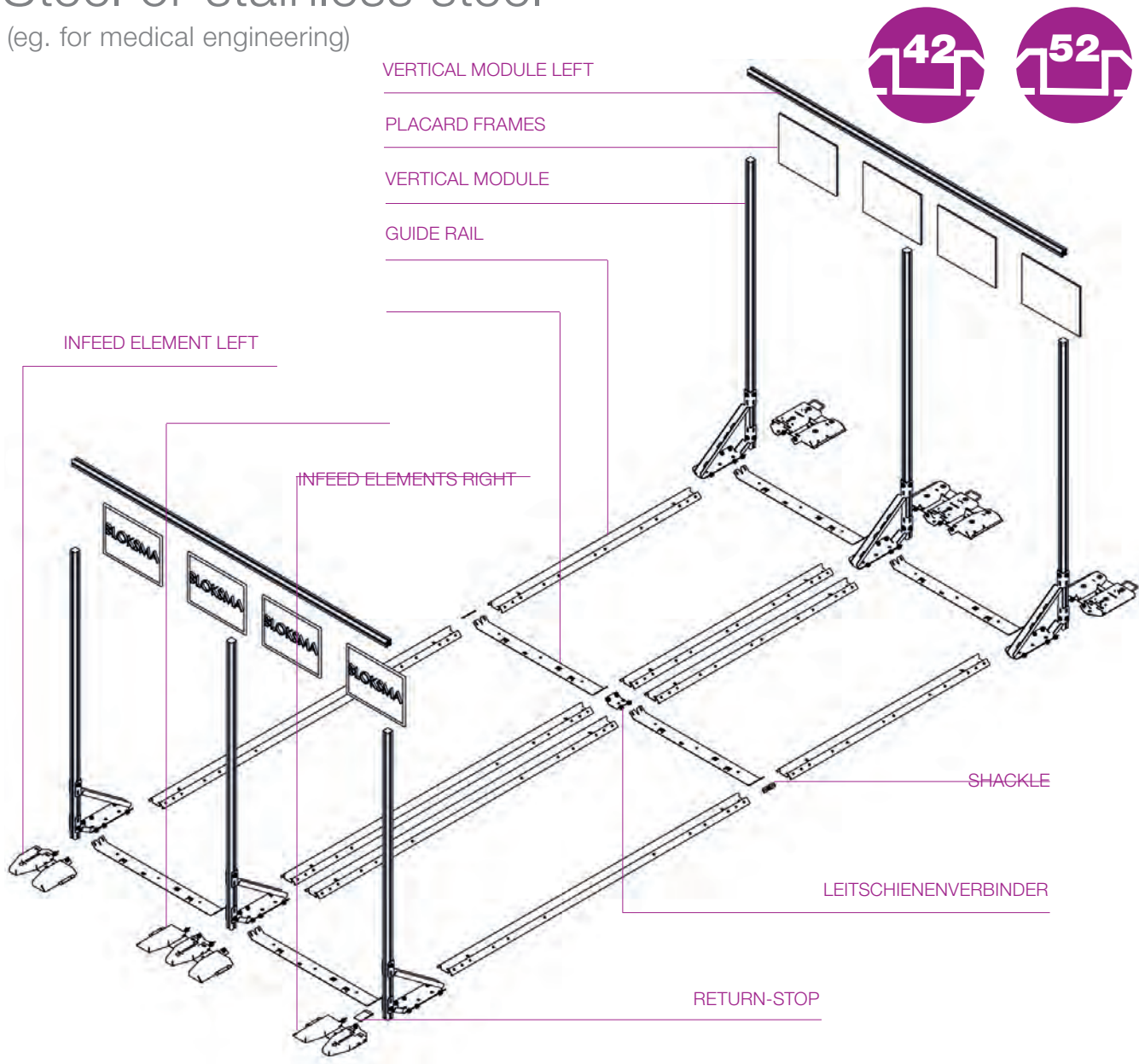

LABELING POSSIBILITIES

- H

HANGING VIA ALU-  
MINIUM PROFILE
- K

HANGING FROM  
CEILING
- D

ROTATABLE VIA ALUMINI-  
UM PROFILE
- P

STANDING
- B





STANDING VIA ALUMI-  
NIUM PROFILE



SUPERMARKET ACCESSORIES I  
PLACARD FRAMES

Components for labeling

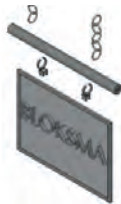
Example: **201030-A504** placard frame standing, size A5 in blue



Item no.	DIN Ax	paint	description	model
201031	A ____	____	BG-Placard frame <b>complete</b> with foil and closing clip	
201034	A ____	____	BG-Placard frame <b>B standing</b> incl. fixing material	
201032	A ____	____	BG-Placard frame <b>H hanging via aluminium profile</b> incl. fixing material	
201033	A ____	____	BG-Placard frame <b>K hanging from ceiling</b> incl. fixing material	
201030	A ____	____	BG-Placard frame <b>P standing via aluminium profile</b> incl. fixing material	
201546	A ____	____	BG-Placard frame <b>D rotatable</b> incl. fixing material	
DIN A3 DIN A4 DIN A5		01 = yellow 02 = red 03 = white 04 = blue 05 = green 06 = black		

Other models / dimensions on request  
Subject to technical changes

SUPERMARKET ACCESSORIES II  
SINGLE COMPONENTS

Components for labeling

Example: **201524-A504** single placard frame size A5 in blue  
**201525-A5** foil for placard frame size A5

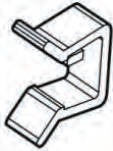
Item no.	DIN Ax	paint	description	model
201524	A ____	____	placard frame separately	
201525	A ____	transparent	foil for placard frame	
147711	size standardized	transparent	closing clip for placard frame	
DIN A3 DIN A4 DIN A5		01 = yellow 02 = red 03 = white 04 = blue 05 = green 06 = black		

Other models / dimensions on request  
Subject to technical changes



SUPERMARKET ACCESSORIES III  
SINGLE COMPONENTS

Components for mounting

Item no.	description	model
----------	-------------	-------

FIXING FOR PLACARD FRAME P

STANDING

202355	BG-holder consisting of holder and mounting contents: 2 pieces
140196	holder for placard frame - standing - contents: 1 piece
141332	BG-mounting plate contents: 1 piece

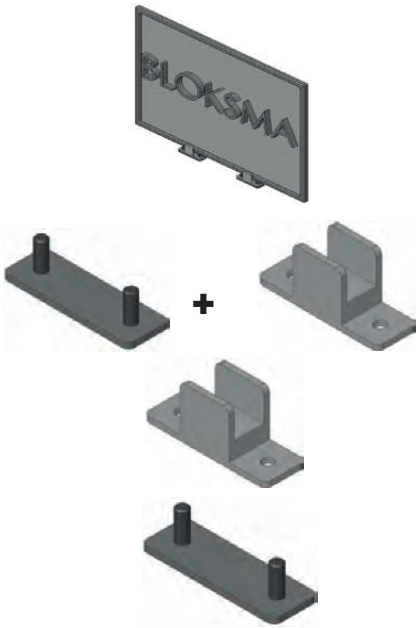

FIXING FOR PLACARD FRAME B

STANDING VIA ALUMINIUM PROFILE

142113	BG-holder for placard frame standing contents: 2 pieces inclusive mounting material
--------	--



Other models / dimensions on request  
Subject to technical changes

SUPERMARKET ACCESSORIES IV  
SINGLE COMPONENTS

Components for mounting

Item no.	description	model
----------	-------------	-------

FIXING FOR PLACARD FRAME K

HANGING FROM CEILING

142405	link chain 30m
142404	locking hook for link chain contents: 10 pieces
142406	mounting tube Ø 28 mm L = 2.420mm
142403	holder for placard frame at mounting tube contents: 10 pieces



FIXING FOR PLACARD FRAME H

HANGING VIA ALUMINIUM PROFILE

138768	suspension hook - rotatable
140863	eyelet M6x15 - closed
133427	nut M6 8 mm groove





Other models / dimensions on request  
Subject to technical changes

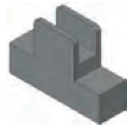
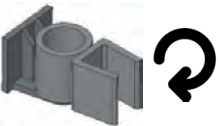

SUPERMARKET ACCESSORIES V  
SINGLE COMPONENTS

Components for mounting

Item no.	description	model
140870	suspension eye closed - rotatable	
142415	placard frame holder magnetic	
142416	placard frame holder vertically rotatable	
142503	holder for placard frame at mounting tube	
142418	placard frame holder vertically adhesive on wall	

Other models / dimensions on request  
Subject to technical changes

SUPERMARKET ACCESSORIES VI  
FURTHER COMPONENTS





Item no.	description	model
133176	angle connector 90 degrees for 30x30mm profile	
132399	angle connector 90 degrees for 40x40mm profile	
134473	angle connector 90 degrees for 30x30mm profile	
138146	angle connector 45 degrees for 30x30mm profile	
202829	angle connector 45 degrees for 40x40mm profile	
202411	collar nut M5	
135649	collar nut M6	
135997	collar nut M8	
202830	hammer screw M5x16	
135650	hammer screw M6x16	
135996	hammer screw M8x20	
132401-xxxxA	aluminium profile 30x30mm	
132402-xxxxA	aluminium profile 40x40mm	
139727	profile connector 8 mm groove for Alu-profile 30x30 mm	
133427	nut	
132407	cap Alu-profile	
132917-xxxx	plastic cover profile for check rail 8mm groove (max. 2000mm - please fill in the required length)	

Other models / dimensions on request  
Subject to technical changes

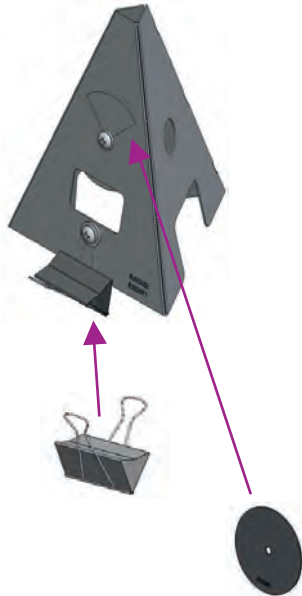
SUPERMARKET ACCESSORIES VII  
SINGLE COMPONENTS

Track marking in the supermarket

Item no.	description	model
		
202632-X001	pintle	
202632-X002	pintle turning platform	
202632-X003	pintle with clip	
202632-X004	pintle with retaining clip & turning platform	
202874	BG-retaining clip	
202875	BG-turning platform	

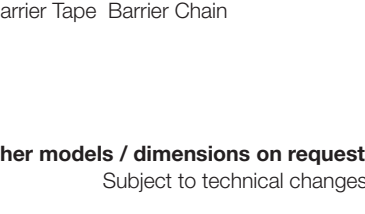
202359	Rail Barrier Fix		
202360	Rail Barrier Tape		
202796	Rail Barrier Chain (Kette)		

Examples

Barrier Tape   Barrier Chain

Other models / dimensions on request  
Subject to technical changes

SUPERMARKET ACCESSORIES VIII  
SINGLE COMPONENTS

Collection box/Mailbox

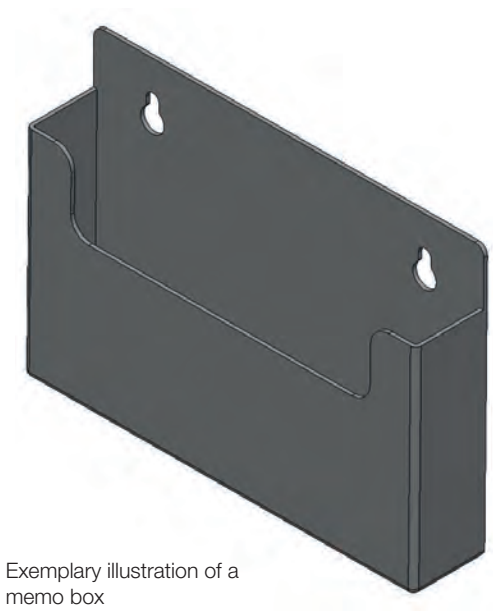

Exemplary illustration of a  
memo box

Item no.	description
200503-16x11	memo box 165x115mm to collect KANBAN cards or other order documents
200503-25x23	memo box 250x230mm to collect KANBAN cards or other documents

Other models / dimensions on request  
Subject to technical changes



# SUPERMARKET WITH AUTOMATED REFILL OPTION



Article 210545 Automated refill device



Supermarket with automated refill devices

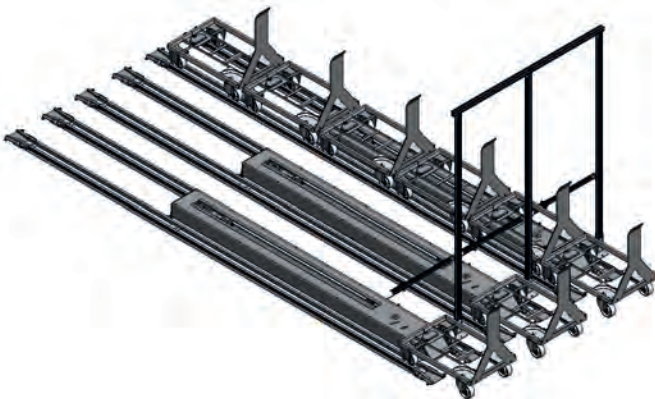

Supermarket with automated refill devices



Slide mechanism - change of rail

# FIFO SUPERMARKETS - THE NEXT LEVEL

SUPERMARKETS SUPPORT THE STORAGE OF TROLLEY AFTER FIRST IN FIRST OUT PRINZIP. THIS PRINCIPLE WAS FURTHER DEVELOPED BY BLOKSMA AND EQUIPPED WITH COMPLEMENTARY INTELLIGENCE.



Long and narrow supermarkets tracks are problematic for workers, because they have great difficulty removing the front trolleys.  
Thanks to the automatic refill function thought of by BLOKSMA, this problem is resolved. With this function it is guaranteed that the trolley entered first will always be ready at the end of the rail track for first removal.  
The sensors of the automatic refill supermarket will recognize which position the trolley is in. Should the front sensor not be occupied then automatically a trolley will be moved forward from the back. The automatic supermarket will move a trolley from back to front after each removal.  
The length of the supermarket with automatic refill function can be manufactured per customer requirements.

Further models/dimension available upon request.

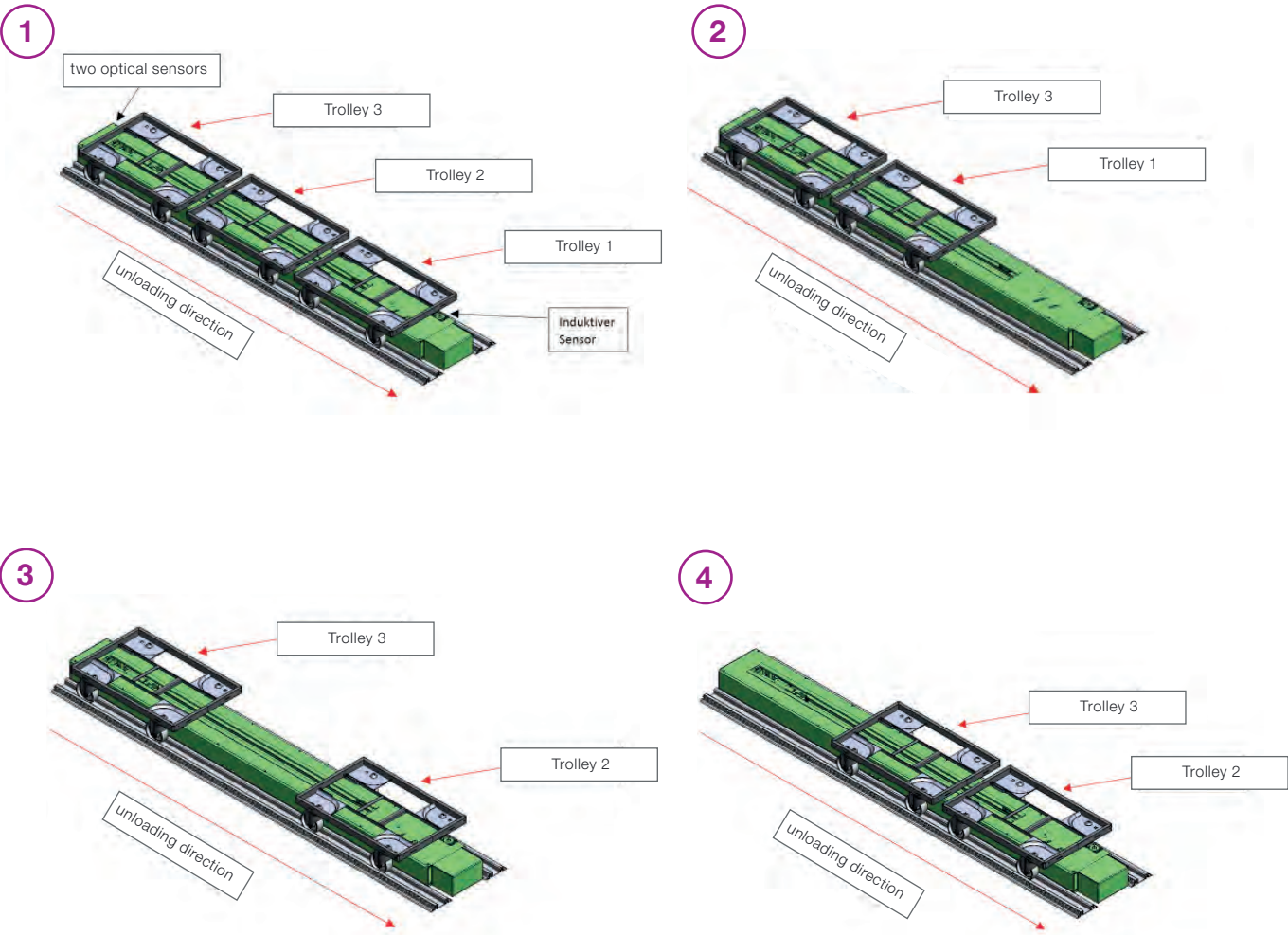



SUPERMARKET  
TOP-STRUCTURE • HOUSING

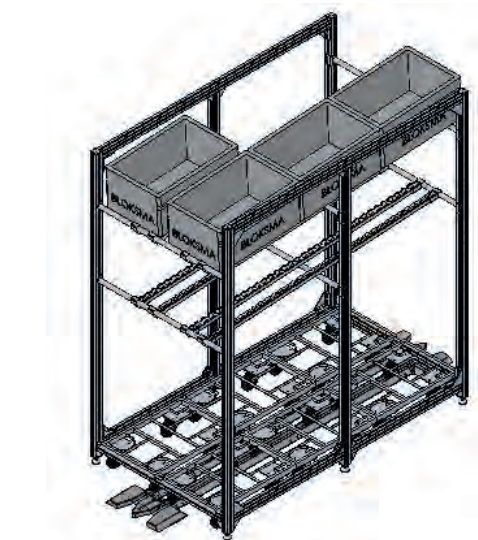

Top structure with conveyor belt on shelf

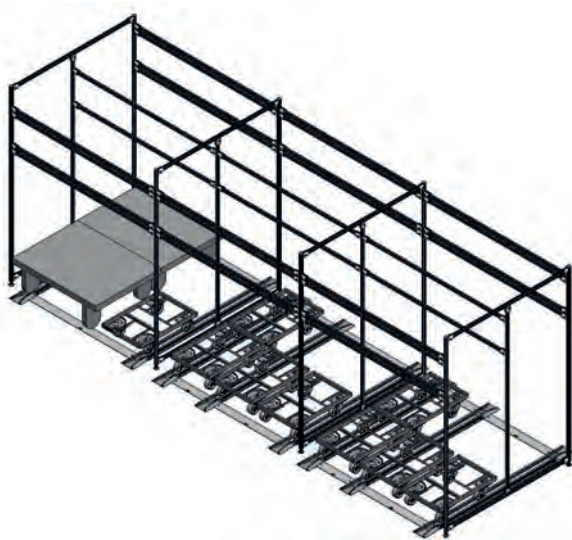

Top structure with conveyor belt on shelf



with housing

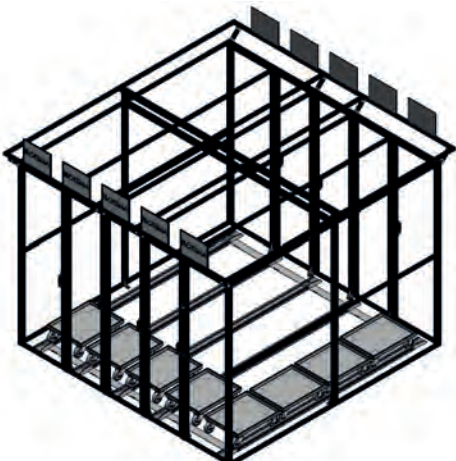

Top structure with labeling



Top structure with conveyor belt on shelf

SUPERMARKET  
FURTHER ACCESSORIES

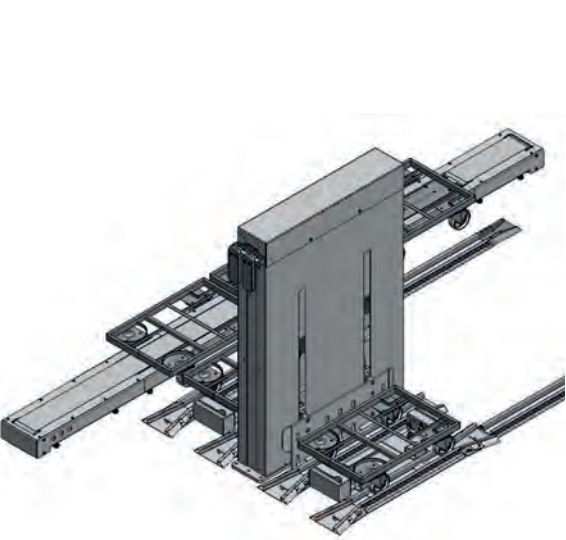

Article 202361 lifter integrated in supermarket

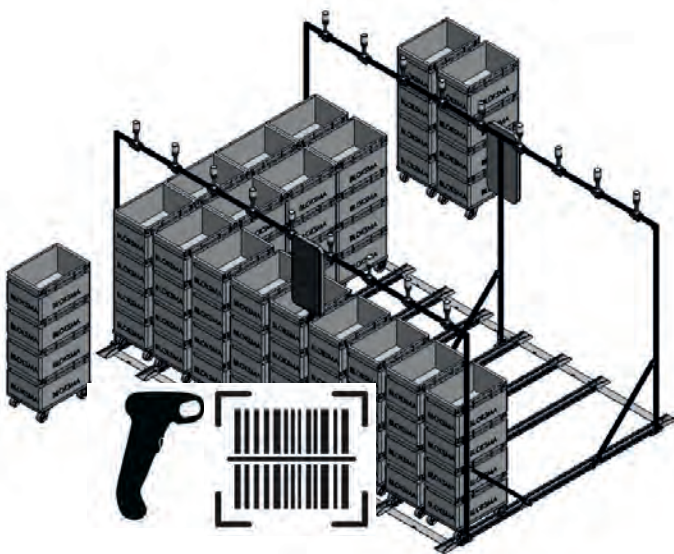

Supermarket guard

- Prevents wrong positioning of trolleys
- Errors have visual and/or audible signals
- Constructed for error prevention and time saving
- Modern technical support for your perfect material flow
- Suitable for any number of tracks and applications

For more comprehensive product information please contact your local sales person - we will be at your disposal with our support!!  
[www.bloksma.de/en/contact](http://www.bloksma.de/en/contact)



OUR SERVICE FOR YOU

- BLOKSMA will gladly advise you and design the supermarket according to your application
- If desired, we set up your supermarket on site
- Contact us: 07181 98556-0 or by mail [mail@bloksma.de](mailto:mail@bloksma.de)



## TROLLEY PARKING

EVERYTHING IN PLACE,  
SO NOTHING  
ROLLS AWAY

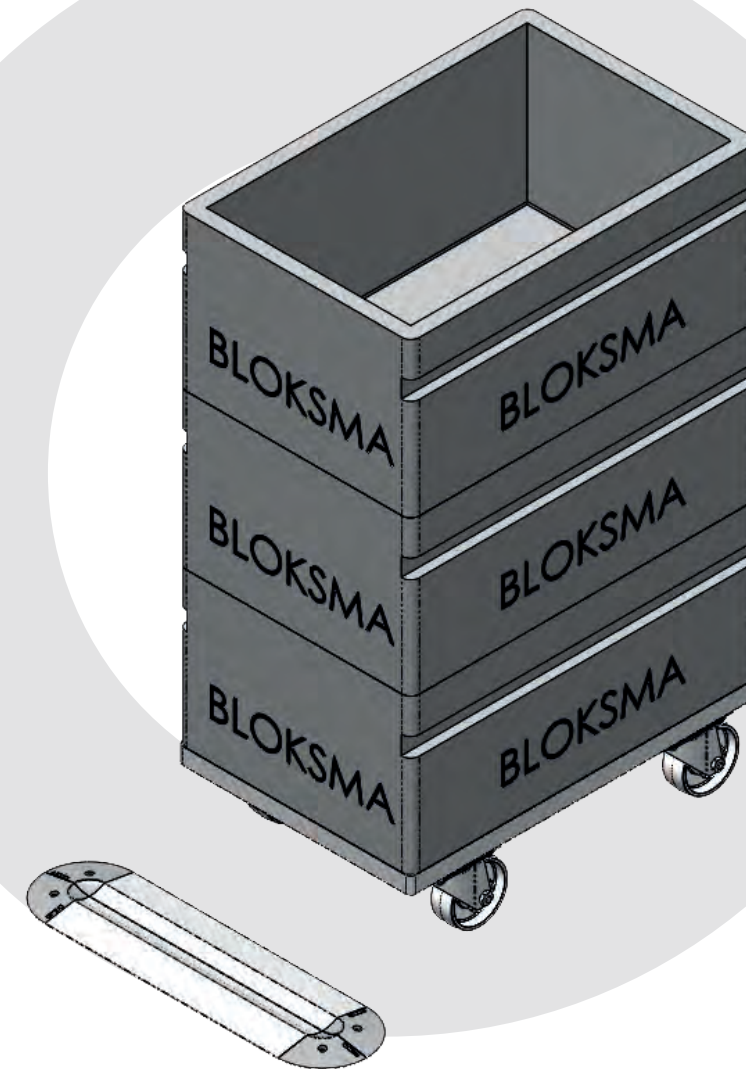

# PARKING LOT

Everything in place, so nothing rolls away.

Parking Lot (with stacks of KLT or GLT)

- Secure against unintentional rolling away
- Secure the right parking position
- Provide optimal visual overview
- Integral element 5S

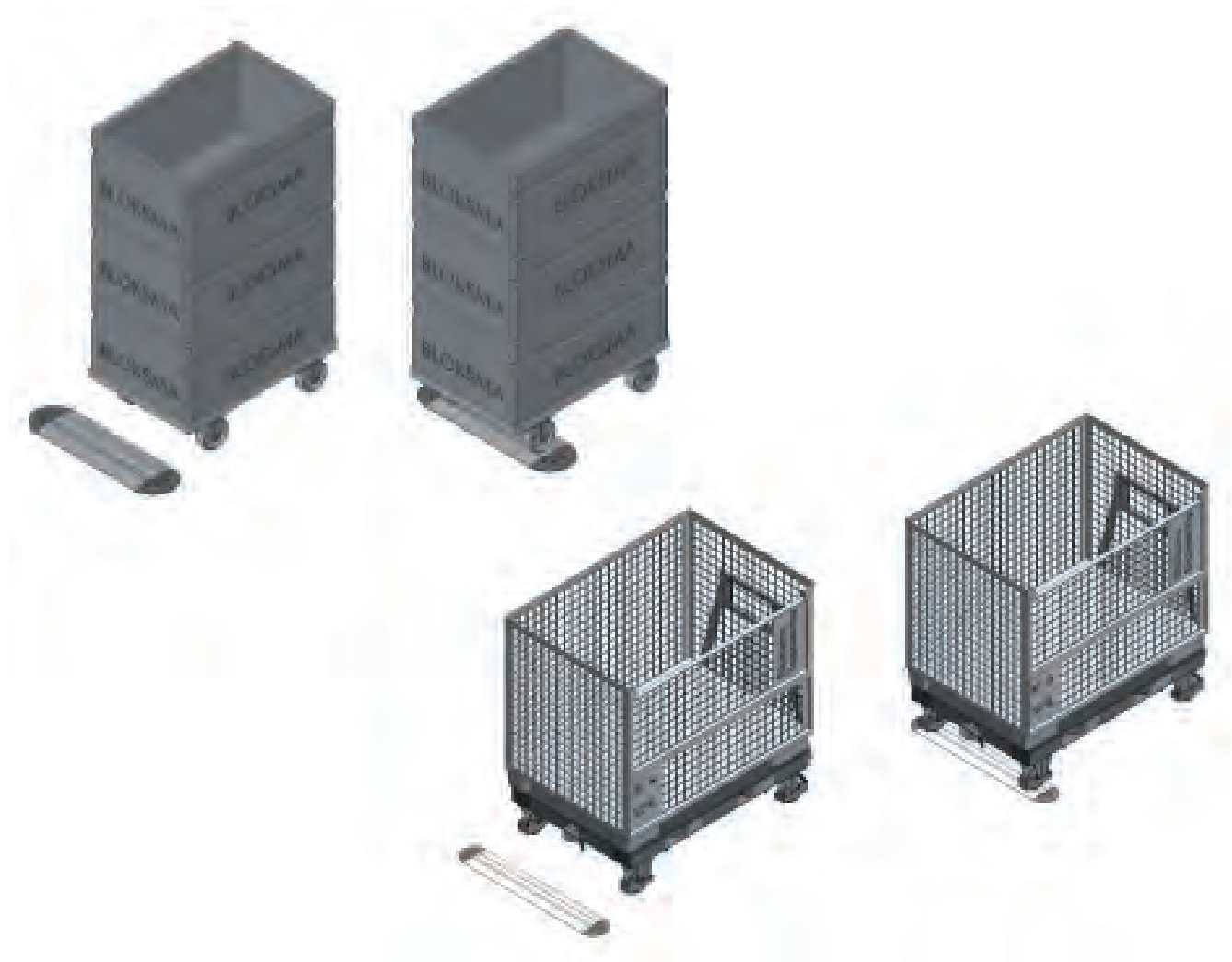

# OVERVIEW

COMPLETE-SET „HIGH – HIGH”	page 174
COMPLETE-SET „FLAT – FLAT”	page 175
COMPLETE-SET „HIGH -FLAT”	page 176
COMPLETE-SET „HIGH-HIGH” LARGE WHEELS	page 177
SINGLE COMPONENTS	page 178-181



PARKING LOT 10mm  
COMPLETE-SET

Version „high-high“

Securing the trolley at the workstation against unintentional movement.  
The parking lots are designed modularly.  
Therefore it is possible to purchase single elements as well.

FOR WHEEL DIAMETER:

- up to 100mm

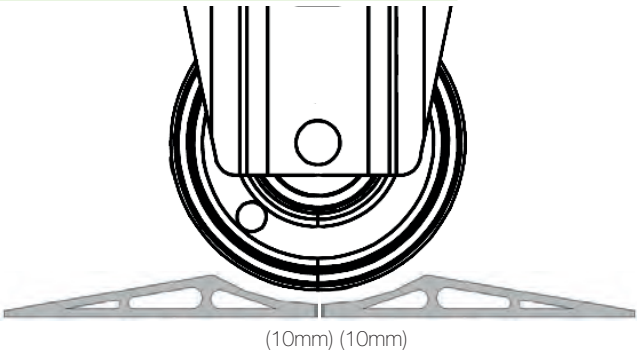

Example: **200441-0400A** Parking lot set „high-high“ with a length of 400mm (anodized)

Item no.	length	processing	model
200441-xxxxx	_____	—	

Please fill in the required length of the rail in mm. A = anodized B = pasted with warning tape (black and yellow)

THIS PARKING LOT SET CONSISTS OF

Item no.	length	processing	description and quantity	model
138729-H-H	size standardized	plastic	1x end piece set parking lot (contents per set: 4 pieces)	

200448-xxxxx	_____	—	1x Alu parking lot guide rails 10mm high (contents per set: 2 pieces)	
	Please fill in the required height of the rail in mm .	A = anodized B = pasted with warning tape (black and yellow)		

Other models / dimensions on request  
Subject to technical changes

PARKING LOT 6mm  
COMPLETE SET

Version „flat-flat“

Securing the trolley at the workstation against unintentional movement.  
The parking lots are designed modularly.  
Therefore it is possible to purchase single elements as well.

FOR WHEEL DIAMETER:

- up to 100mm

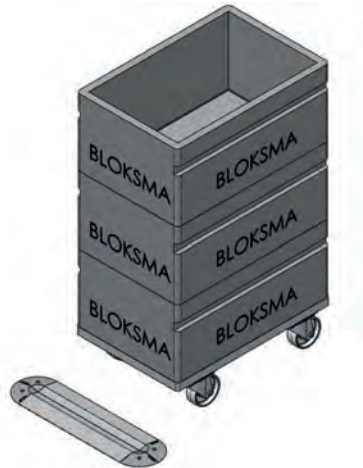
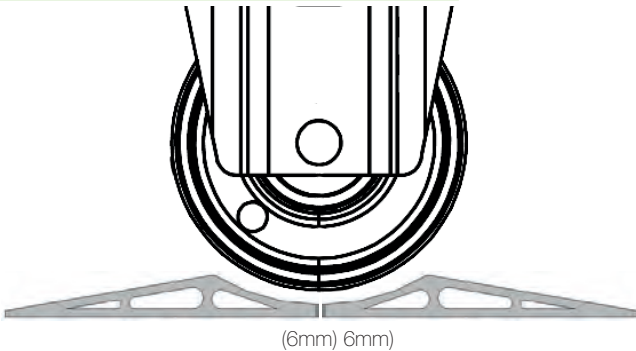

Example: **200443-0400A** Parking lot set „flat-flat“ with a length of 400mm (anodized)

Item no.	length	processing	model
200443-xxxxx	_____	—	

Please fill in the required length of the rail in mm. A = anodized B = pasted with warning tape (black and yellow)

THIS PARKING LOT SET CONSISTS OF

Item no.	length	processing	description and quantity	model
138729-N-N	size standardized	plastic	1x end piece set parking lot (contents per set: 4 pieces)	

200449-xxxxx	_____	—	1x Alu parking lot guide rails 6 mm low (contents per set: 2 pieces)	
	Please fill in the required height of the rail in mm.	A = anodized B = pasted with warning tape (black and yellow)		

Other models / dimensions on request  
Subject to technical changes

## PARKING LOT 10MM-6MM COMPLETE-SET

## Version „high-flat“

Securing the trolley at the workstation against unintentional movement.  
The parking lots are designed modularly.  
Therefore it is possible to purchase single elements as well.

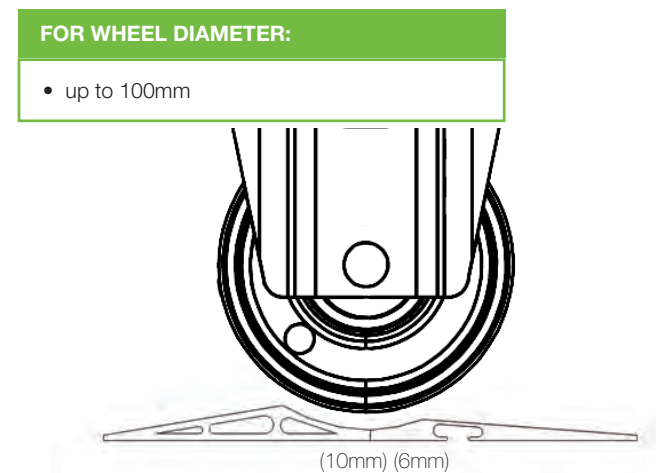

Example: **200442-0400A** Parking lot set „high-flat” with a length of 400mm (anodized)



Item no.	length	processing	model
200442-xxxxx	— — — —	—	

Please fill in the required length of the rail in mm.

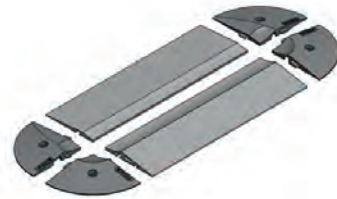
A = anodized  
B = pasted with warning tape (black an yellow)



THIS PARKING LOT SET CONSISTS OF

Item no.	length	processing	description and quantity	model
138729-H-N	size standardized	plastic	1x end piece set parking lot (contents per set: 4 pieces)	
141427-xxxxx	— — — —	—	1x Alu parking lot guide rails 10mm high (contents per set: 1 piece)	
144417-xxxxx	— — — —	—	1x Alu parking lot guide rails 6mm low (contents per set: 1 piece)	

Please fill in the required length of the rail in mm.

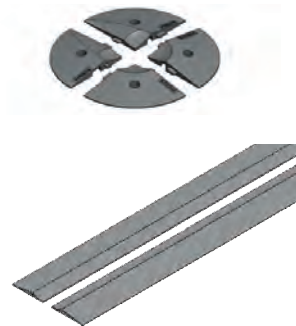

**Other models / dimensions on request**  
Subject to technical changes

## PARKING LOT 10MM COMPLETE-SET

## Version „high-high“ large wheels

Securing the trolley at the workstation against unintentional movement.  
The parking lots are designed modularly.  
Therefore it is possible to purchase single elements as well.

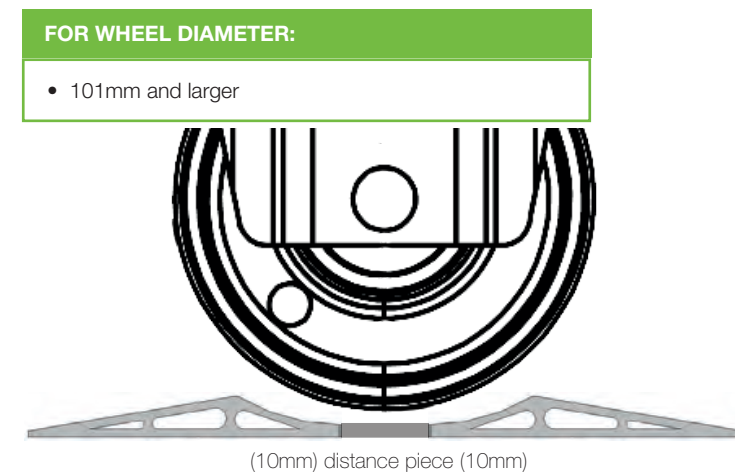



Example: **210840-0400A** Parking lot set „high-high“ with a length of 400mm and distance piece, (anodized)

Item no.	length	processing	addition	model
210840-xxxxx	— — — — —	—	with distance piece (20mm) for wheel Ø 101-150mm	
210841-xxxxx	— — — — —	—	with distance piece (30mm) for wheel Ø 150-180mm	
210842-xxxxx	— — — — —	—	with distance piece (40mm) for wheel Ø more than 180mm	

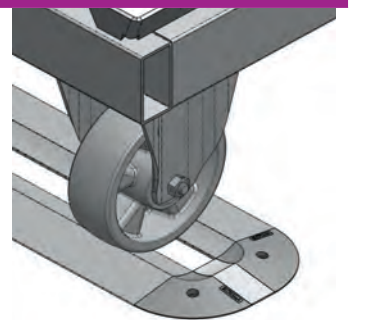
Please fill in the required length of the rail in mm.



THIS PARKING LOT SET CONSISTS OF

Item no.	length	processing	description and quantity	model
138729-H-H	size standardized	plastic	1x end piece set parking lot (contents per set: 4 pieces)	
200448-xxxxx	— — — — —	—	1x Alu parking lot guide rails 10mm high (contents: 2 pieces)	
+ Spacers depending on wheel diameter (see page 180)				

Please fill in the required length of the rail in mm.

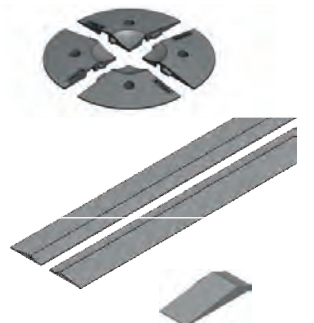

**Other models / dimensions on request**  
Subject to technical changes



# PARKING LOT

## SINGLE COMPONENTS

### Rails

Securing the trolley at the workstation against unintentional movement.  
The parking lots are designed modularly.  
Therefore it is possible to purchase single elements as well.

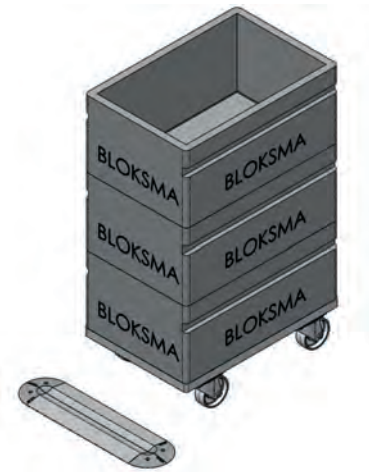
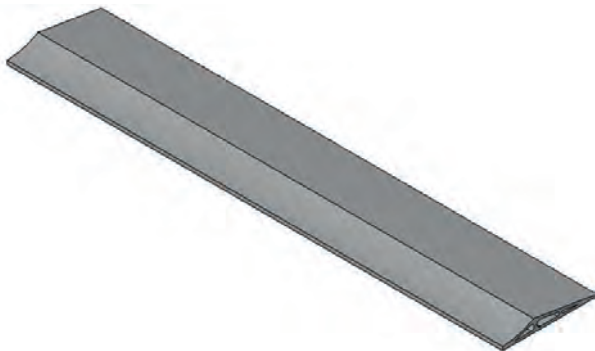

### INDIVIDUAL RAILS

Example: **141427-0400A** aluminium parking lot rail - high with a length of 400mm, (adonized)

Item no.	length	processing	description	model
141427-xxxxx	_____	—	Alu parking lot guide rails 10mm high (contents per set: 1 piece)	
144417-xxxxx	_____	—	Alu parking lot guide rails 6mm high (contents per set: 1 piece)	
Please fill in the required height of the rail in mm.		A = anodized B = pasted with warning tape (black and yellow)		

### RAILS IN SET OF TWO

Example: **200448-0400A** two aluminium parking lot rails - high with a length of 400mm, (adonized)

Item no.	length	processing	description	model
200448-xxxxx	_____	—	Alu-parking slot rail 10mm high (content: 2 rails)	
200449-xxxxx	_____	—	Alu-parking slot rail 6mm low (Inhalt: 2 rails)	
please insert prefered rail height		A = anodized B = beklebt mit schwarz/ gelben Warnband		

# PARKING LOT

## SINGLE COMPONENTS

### End pieces

Securing the trolley at the workstation against unintentional movement.  
The parking lots are designed modularly.  
Therefore it is possible to purchase single elements as well.

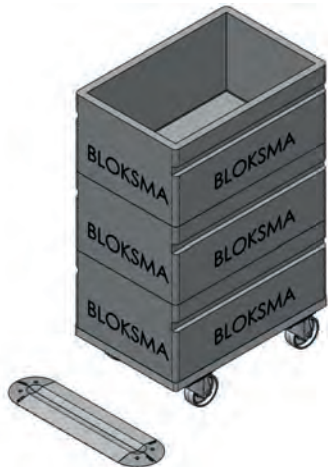

### END PIECES

Item no.	description	model
138729-H-H	end piece parking lot contents per set: 4 pieces (screw/dowel) for height of rail 10mm/10mm	
138729-N-N	end piece parking lot contents per set: 4 pieces (screw/dowel) for height of rail 6mm/6mm	
138729-H-N	end piece parking lot contents per set: 4 pieces (screw/dowel) for Schienenhöhe 10mm/6mm	
201532-20	screw + dowel (contents per set: 20 pieces)	

PARKING LOT  
SINGLE COMPONENTS

Distance Piece

Securing the trolley at the workstation against unintentional movement.  
The parking lots are designed modularly.  
Therefore it is possible to purchase single elements as well.

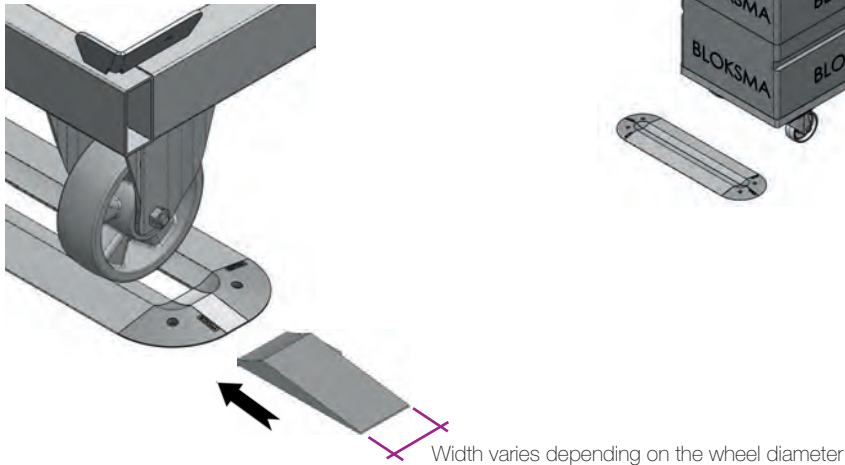

DISTANCE PIECES

Item no.	addition	model
200448-0020A	with distance peace (20mm) for wheel Ø 101-150mm	
200448-0030A	with distance peace (30mm) for wheel Ø 150-180mm	
200448-0040A	with distance peace (40mm) for wheel Ø more than 180mm	

Other models / dimensions on request  
Subject to technical changes

PARKING LOT  
SINGLE COMPONENTS

Floor markings

marking tapes, to give the parking lots individual colors

FLOOR MARKING TAPE

Item no.	paint	description	model
201674-xx	— —	floor making tapes width 50mm - length 50m	
Please select the desired colour and fill in the number of the colour.		01 = yellow 02 = red 03 = white 04 = dark blue 05 = green 06 = black 07 = orange 08 = light blue 09 = black-yellow warning tape 10 = blue-white warning tape	
290095	colourless	cleaner for parking lot	

Other models / dimensions on request  
Subject to technical changes



# ALLES AUS EINER HAND.

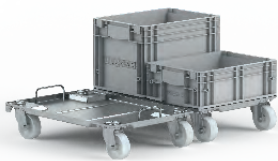

1 | TROLLEYS



2 | LIFTERS



3 | SUPERMARKET  
& PARKING SLOT



5 | TRANSPORT-  
LOGISTIK



6 | VISUALIZIERUNG

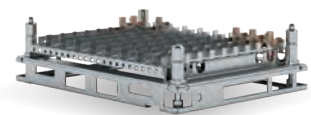

7 | WORK PIECE  
CARRIER



[www.bloksma.de](http://www.bloksma.de)



Reg.-Nr.: Q1 0299012



**FSC**  
[www.fsc.org](http://www.fsc.org)

MIX

Aus verantwortungs-  
vollen Quellen

FSC® C016267

**BLOKSMA-Engineering GmbH**

Daimlerstraße 10  
D – 73660 Urbach near Stuttgart  
Tel: +49 7181 98556-0  
Fax: +49 7181 98556-42  
[mail@bloksma.de](mailto:mail@bloksma.de)  
[www.bloksma.de](http://www.bloksma.de)